

CLEANING Interior Instructions

CARING FOR YOUR INTERIOR WINDOW SHADES



Product: Draper® FlexShade®. The Austonian Luxury Residences in Austin, TX.
Installer: Capitol Blind & Drapery, Austin, TX. Photo: © Matt Oberer www.mattphoto.net

GENERAL CLEANING

You can clean most Draper shade fabrics at the window. Use a vacuum with a soft brush attachment, a soft duster, or compressed air.

CLEANING SOILED SHADES

For dirt or stains, on many fabrics you can use a sponge or soft cloth and mild solution of warm soapy water. We recommend a dishwashing liquid, such as Ivory liquid. Commercial and hospital grade cleaners/disinfectants or a 10% or less diluted bleach solution may be used. Test in an inconspicuous area prior to use. Rinse thoroughly after cleaning.

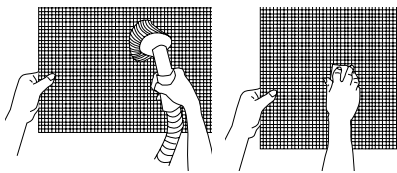

Left: Vacuuming with a soft brush attachment.
Right: Cleaning with a soft cloth/art sponge.

Caution: Be sure to steady fabric with one hand during cleaning. Be careful not to jerk or place weight on the fabric. Depending on the installation hardware and substrate, placing too much weight on the fabric could result in mounting hardware being pulled loose.

EXCEPTIONS*

Do not use water or other liquids to clean the following fabrics. Use a soft duster, compressed air, or a low-suction vacuum.

- Phifer SheerWeave: SW7000**, SW7200R/7250R, SW7400/7450, SW7500/7500R, SW7600/7650, SW7700R/7750R, SW8000
- Mermet USA: GreenScreen Evolve, GreenScreen Revive, GreenScreen Nature, Flocke**, Vizela, Verona Daylight, Verona Twilight
- Draper®: Linen Light, Linen Light Blackout, Malacca, Oslo, Oslo Blackout, Tenley, Venice Blackout

* If you aren't sure which shade fabric you have, please contact Draper support.

** A dry art sponge can be used on Phifer SW7000 fabrics, Mermet USA Flocke, and Draper Palister, Fury, and Tenley.

Fabrics with metallized backing: If your shade has a metallized backing do not use liquids, and do not rub the metallized surface. The only recommended cleaning methods are a soft duster, compressed air, or a low-suction vacuum. (The non-metallized "room side" can be cleaned using the standard methods mentioned above.)

FABRIC HANDLING

Use care when cleaning fabric to avoid creating creases or wrinkles. A flat surface may be held behind the shade surface to provide support while cleaning.

A note on vacuuming: When vacuuming, avoid pulling or stretching the fabric. Rigorous vacuuming is not recommended since this could distort the fabric. Alternatively, dirt and debris can be blown away using compressed air or hand-held air dryer on the cool setting. A dry chemical sponge may also be used for spot cleaning.

Please Note: If none of these cleaning methods work, please call Draper for additional help.